

# STD-P096 Hands Free Stand/Holder Mounting Instructions



## General Features

The STD-P096 is a stand for PowerScan™ 9600 family bar code readers, for hands-free operation. It also helps to keep the reader's handle within the operator's reach. The mounting kit supplied with the stand contains the following components:

- 1 fixing screw
- 4 self-tapping screws
- 2 adhesive strips
- 4 adhesive bumpers

## Using the STD-P096

Insert the reader into the stand as shown at left. Rotate the holder as needed to position the reader for the best orientation with respect to the bar codes.

## Assembling the STD-P096

To assemble the STD-P096 follow the steps below:

1. Fix the reader support (1) to the central support (2) by using the positioning screw (3).
2. Position the assembly by screwing the central support (2) into the tube (4).
3. Position the tube into the base housing (5) and fix it (4) by using the fixing screw (6).

## Fixed Desktop Use

The STD-P096 can be fixed to a surface using either the four self-tapping screws (7) or the two double-sided adhesive strips (8).

If you don't want to fix the stand to any surface, you can stick the four adhesive bumpers (9) to the bottom of the base for a greater stability of the stand and also to prevent the base from sliding if the surface is particularly smooth.

## Mounting with screws

After making sure that the STD-P096 is correctly assembled, fix the base to the desired surface by means of the four self-tapping screws (7).

## Mounting with adhesive strips

If you want to fix the stand to the desired surface using the adhesive strips, follow the steps below:

1. Carefully clean the bottom surface of the base with alcohol to remove any impurities that could reduce the adhesion.
2. Remove the protective plastic from one side of the two adhesive strips (8) and stick them onto the bottom surface of the base.
3. Remove the plastic from the other side of the strips and affix the STD-P096 to the desired surface.

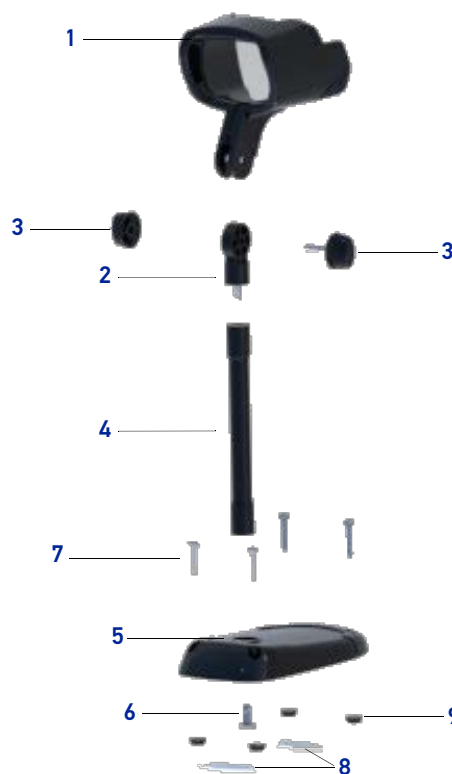

**NOTE: The surface must be smooth and clean to allow correct adhesion.**

