

DATECS

USER'S MANUAL

ESC/POS
Thermal Printer
DPP-350



We wish you a pleasant work
with DPP-350!

The information contained in this document is subject to change without prior notice.
All rights reserved. Any mechanical, electrical or electronic reproduction
or adaptation of the information in this document
without prior written permission from DATECS Ltd. is prohibited

1784 Sofia, Bulgaria, 115A Tzarigradsko shosse blvd.
Tel.: +359 2/8165 500, 8165 501, 8165 506, 8165 511; Fax: +359 2/8165 510
E-mail: sales@datecs.bg

Version: october 2009 r. / firmware version 1.59

C O N T E N T S

DATECS DPP-350

Introduction

Main features	4
---------------------	---

1. Technical Specifications	5
-----------------------------------	---

2. Safety Instructions	7
------------------------------	---

3. Confirmation of Carton Contents	9
--	---

4. Part Names and Functions

Front / Right View	10
--------------------------	----

Front / Left View	11
-------------------------	----

ON/OFF button and LF button Functions	12
---	----

LEDS	13
------------	----

Magnetic Card Reader	14
----------------------------	----

Smart Card Reader	15
-------------------------	----

5. Setup

DIP Switch Settings	16
---------------------------	----

Printer Configuration	17
-----------------------------	----

Memory Switches Setup	18
-----------------------------	----

Saving and Clearing PAIRING Info	19
--	----

Connecting Device	20
-------------------------	----

Bluetooth Setup	21
-----------------------	----

Loading Drivers for DPP-350	22
-----------------------------------	----

Charging the Battery	23
----------------------------	----

Replacing the Battery	24
-----------------------------	----

Loading Paper	25
---------------------	----

SELF TEST Printing	26
--------------------------	----

6. Troubleshooting	28
--------------------------	----

7. List of Commands for ESC/POS mode	29
--	----

INTRODUCTION

DATECS DPP-350

/// Main Features ///

DATECS DPP-350 is a mobile ESC/POS thermal printer with 3-inch wide printing mechanism. It can be used in dynamic working conditions and its abundant built-in features allow it to be widely used for different applications. Printer can quickly and easily print text and/or graphics, depending on customer's needs – barcodes, logo, etc.

Features:

- Small and lightweight, for real mobility;
- High speed and low noise, owing to line thermal print;
- Easy paper-loading;
- Can be used with 2 types of thermal paper – 78 mm or 58 mm wide;
- Long lasting battery – max 30000 lines per charge;
- Serial RS232 and USB interfaces;
- Supports protocol for POS and BARCODE;
- Capable of printing alpha-numeric and graphical data;
- Drivers for Pocket PC, Palm OS, Windows and Blackberry.

Configuration Options:

- Bluetooth interface;
- Magnetic Stripe Reader (3 track);
- Smart Card Reader;
- MIFARE card Reader;
- SD card slot reader;
- Built-in metal belt hook and neck lanyard.

DATECS DPP-350 corresponds to the European safety directives:

EN 55022:2006 – class B, EN 61000-3-2:2006, EN 61000-3-3:2000+A1:2003+A2:2006, EN 55024:2001+A1:2002+A2:2003, EN 55022:2001+A1:2002+A2:2003.

No deviations from standard norms.

DATECS DPP-350 has passed a functional test In Datecs Development Department. It was tested in ESC/POS operation mode in configuration with the Intel Pentium 4 computer, CPU 2.86 GHz, 480 MB RAM, using a Datecs Development Department program. The number of tested devices is one – factory number S / N AAA000001BB07, 1.12 firmware version (by Datecs Development Department).

Parameter	Description	
Printing	Printing Method	Line thermal dot printing
	Printer mechanism	FTP-638MCL 103
	Resolution	203 dpi (8 x 8 dots/mm)
	Dot pitch	Horizontal – 0.125 mm (8 dot/mm) Vertical – 0.125 mm (8 dot/mm)
	Max. Print Width	72 mm / 576 dots per line
	Paper Feed System	Step
	Printing Speed	60 mm/s
	Print lines per charge	30 000
Fonts	Resident Fonts	Font A: 12 x 24 dots (48 char. per line); Font B: 9 x 16 dots (64 char. per line);
	Loadable	Font C: 12 x 24 dots (48 char. per line); Font D: 9 x 16 dots (64 char. per line);
	Japanese vers. only	Font E (JIS and Shift-JIS): 24 x 24 dots (28 char. per line);
	Chinese vers. only	Font F (GB2312): 24 x 24 dots (28 char. per line);
Media: Roll Thermal Paper	Recommended Paper	78 mm x 50 mm diameter 57 mm x 50 mm diameter (option)
Resident Barcodes	1D	EAN 13 EAN 8 UPC A UPC E Codabar Code 39 Code 128
	2D	PDF417, QR Code
Logo Registration	1 Black and White	Size: 576 x 248 dots
Interfaces	Serial	RS232 C – max. 115200 bps
	USB	USB v 1.1, compatible with 2.0
	Bluetooth	Option

Parameter		Description
Emulation	ESC/POS	Continuous paper Mode
		Label/Black Mark Mode
Readers	"Smart Card" Reader	Option
	Magnetic Card Reader	3-track head, ISO 7811 (Option)
	MIFARE Card Reader	ISO 1443-A (Option)
	SD Card Reader	Option
Input Buffer		36 864 bytes (option 131 072 bytes)
Battery	Rechargeable Li-ion battery	7,4 V / 2000 mAh
Adapter	Model:	10AD-E
	Input:	AC 100 – 240 V, 1,3 A, 50/60 Hz
	Output:	DC 9 V, 1 A
Operation switches	Button LF	Paper feed, Self test, Dump Mode
	Button ON/OFF	Switch On/Switch OFF
Power Switch		ON/OFF
Weight	Without paper:	400 g
	With paper:	460 g
Dimensions (mm)		109 (W) X 120 (D) X 63 (H)
Environment	Operating temperature conditions:	Temperature from 0°C to 40°C Humidity from 35% RH to 85% RH
	Storage temperature conditions:	Temperature from -20°C to 60°C Humidity from 10% RH to 90% RH
Reliability	Printing Head:	50 km paper long (printing rate 25% max)
	"Drop" test:	upto 110 cm
	"Waterproof"	
Cables		RS-232 interface cable; mini USB cable A to B cable (option)

SAFETY INSTRUCTIONS

which must be strictly observed!



Warning

Indicates a situation, which if was not observed and handled properly, could result in serious injury.



Caution

Indicates a situation, which if was not observed and handled properly, could result in injury.



Caution

- Prior to operation, read carefully DPP-350 safety instructions and save them for later reference.
- Do not drop or put foreign matter such as clips and pins into the printer. This may cause problems.
- Do not spill drinks such as tea, coffee and juice on the printer or spray insecticide on the printer. If drink or water is spilled, first be sure to turn the power off and then consult our service personnel.
- Be careful when moving or carrying the printer. Dropping the printer may cause injury or property damage.
- When cleaning the surface of the printer case, do not use the cloth that is soaked in thinner, trichloroethylene, benzene, ketone or similar chemicals.
- Operate the control panel properly. A careless, rough handling may cause problems or malfunction. Do not use such sharp-edged tool as a ballpoint pen for operation.
- When printer trouble occurs, do not try to disassemble it. Instead, consult our service personnel.
- Do not disassemble or modify the printer.

Discard or safely store the plastic packing bag.

This bag should be kept away from children.

If the bag is pulled over a child's head, it may cause suffocation.

DATECS NOTICE





- Before use, be sure to read this manual. And keep it handy for reference when needed.
- **DATECS** reserves the right to change the content of this manual without prior notice.
- Reproduction, transfer, or transmission of the contents of this manual without prior consent is strictly prohibited.
- **DATECS** is not liable for any problems resulting from the use of optional products and consumable supplies other than the designated products contained herein.
- Do not handle, disassemble or repair the parts other than those specified in this manual.
- **DATECS** is not liable for any damage caused by user's erroneous use of the printer and inadequate environment.
- Data residing in the printer is temporary. Therefore, all data will be lost if power is lost. **DATECS** is not liable for any damage or loss of profits caused by data loss due to failures, repairs, inspections, etc.
- Please contact us if there are any mistakes or ambiguities within this manual.
We would be grateful!

3

Confirmation of Carton Contents

DATECS DPP-350

When unpacking the printer, check carefully that the following accessories are included in the carton:

Item	Part Name
1	DPP-350 Thermal printer 
2	AC Charger 
3	1 Roll of thermal paper 
4	User's Manual 
5	DPP-350 Drivers 
6	RS232 Interface cable
7	Partition (2 pcs.) for 58/60 mm x Ø 50 mm paper rolls.

Note: Because of the continually evolving Drivers & SDK to support new mobile devices, Drivers & SDK are distributed online and are available for download at our website indicated below:

<http://datecs.bg/support.php?cat=4&soft=1#1>

DPP-350 right view



- ① Power **ON/OFF** Switch.
- ② Paper Feed (**LF**).
- ③ **STATUS LED** – it indicates the printer status.
- ④ **CHARGING LED** – it indicates the battery status.
- ⑤ Charger Input
- ⑥ **USB** port

DPP-350 left view



- ① Serial **RS232**
- ② **Magnetic Card, Smart Card** and contactless **RFID Card Readers LED**
- ③ **Smart Card Reader** (Option)
- ④ **Magnetic Card Reader** (Option)
- ⑤ Contactless **RFID Card Reader** (Option)
- ⑥ Paper Cover Lever
- ⑦ Paper Cover

ON/OFF button and LF button Functions

Button	Functions		
ON/OFF	<ol style="list-style-type: none"> 1. Switch ON / Switch OFF the printer. 2. Holding ON/OFF button while power on for ~ 4 sek. (first sound signal) <ul style="list-style-type: none"> – If serial cable is connected (RS232 communication) – temporary forcing 9600 bps serial speed. – If no serial cable connected (Bluetooth or USB communication) – starting a hardware menu for fast Bluetooth pairing info reset. 3. Holding ON/OFF button while power on for more than 6 sek. – enters hardware setup mode. 		
LF	1. Pressing LF button – feeding the media while the button is pressed, after releasing the button the feeding stops.		
	2. Push and Hold while Power ON – Release after the number of beeps:	After ~ 0.5 sec and after the 1-beep	SHORT SELF TEST print
		After ~ 2.5 sec and after the 2-beep	Hex DUMP mode
		After ~ 4.5 sec and after the 3-beep	LONG SELF TEST print
		After ~ 6.5 sec and after the 4-beep	Program mode – loading the optional card reader firmware
		After ~ 8.5 sec and after the 5-beep 4-tone beep	Program mode – loading the firmware
	3. Pressing LF button in hardware setup mode confirms the changes.		
	4. LF switch operation in black mark mode: Short pressing: feeds one line. Continuous pressing (>1 sec): Feeds the paper to find next black marker (the same as sending FF command).		

LEDS

LED	Function
STATUS	<ol style="list-style-type: none"> 1. It lights green – the printer power is on. 2. It lights red – end of the paper or paper out. After the loading a new paper roll it lights green. 3. It blinks green/red – the printer thermal head is overheat. The printer stops printing. When the printer head temperature returns to normal the STATUS LED lights green and the printer continues to print. 4. It blinks green – low battery. 5. When switching ON the printer, while the LF button is pressed, red and green lights are rotated after every beep (up to the fifth). 6. In the long pressing the button it blinks green/red after a beep. After releasing the ON/OFF button it lights green.
CHARGE	<ol style="list-style-type: none"> 1. It lights green when the adapter is switched ON and the battery is fully charged. 2. It lights red when the adapter is switched ON and the battery is charging.
Magnetic Card, Smart Card and contactless RFID Card Raders LED	<ol style="list-style-type: none"> 1. It blinks green when a magnetic card, Smart Card or MIFARE card is reading.

Magnetic Card Reader (option)

DPP-350 has optional a built-in magnetic card reader. The card reader incorporates a (3)-track magnetic read head requiring a single swipe to read field data from all three tracks.

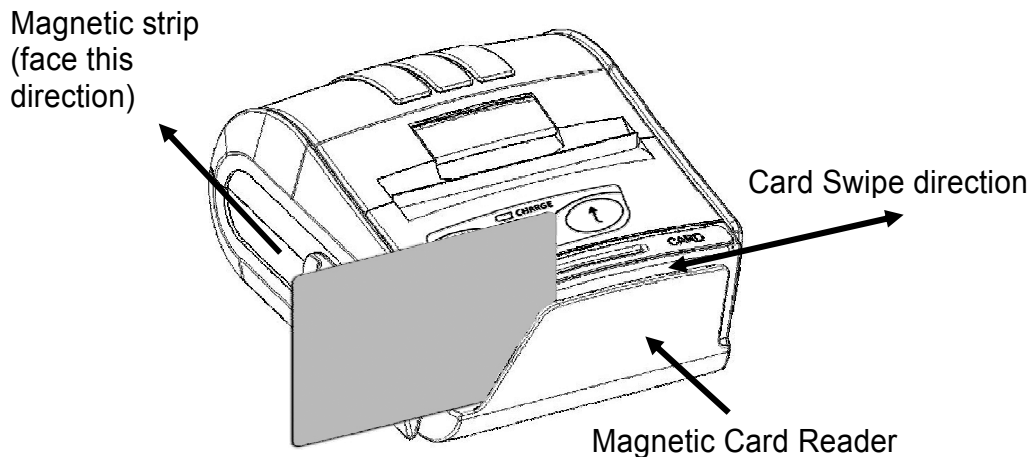

The reader's magnetic head faces towards the front of the printer. When placing the card into the reader, the magnetic strip must be facing as show in the figure above. Keep the bottom edge of the card flat on the inner base of the reader to ensure that the magnetic strip passes over the read head evenly.

When swiping the card through the reader, use an even consistent motion from start to finish.

The speed of swiping can vary however the speed must be consistent from start to finish of the swipe in order to accurately read card data.



To use the magnetic card reader feature, special software must be used to read and process the card information. If you do not have card reading software, please consult your reseller to find out if this software is available or contact DATECS for recommendations on compatible third party software solution.

Smart Card Reader (option)

The DPP-350 has a built-in smart card reader (optional). The smart card reader is designed to read information stored embedded on smart chips and process the information using device side software.

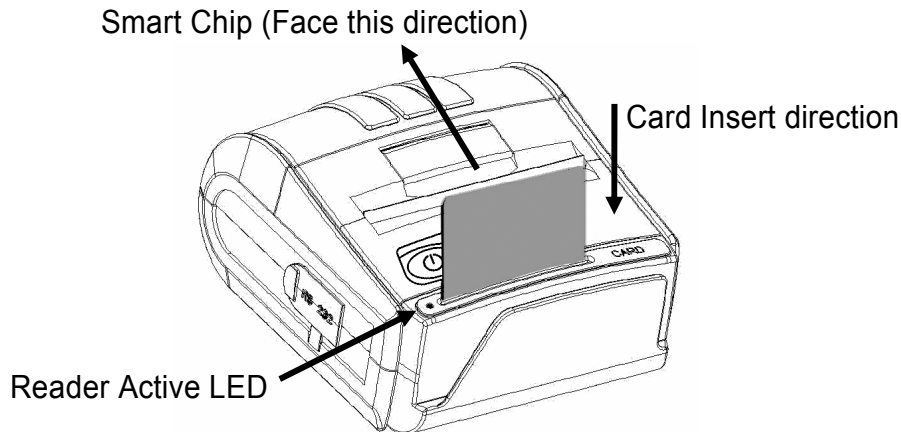

When placing the card into the reader, the smart chip must be facing to the front of the printer as show in the figure above. Insert the card in to the reader until the card stops.



To use the smart card reader feature, special software must be used to read and process the card information. I you do not have card reading software, please consult your resaller to find out if this software is available or contact DATECS for recommendations on compatible third party software solution.

MIFARE Card Reader (option))

The DPP-350 has a built-in MIFAREreader (optional). The MIFAREreader is designed to read information stored embedded on MIFARE contactless cards or tags and process the information using device side software.

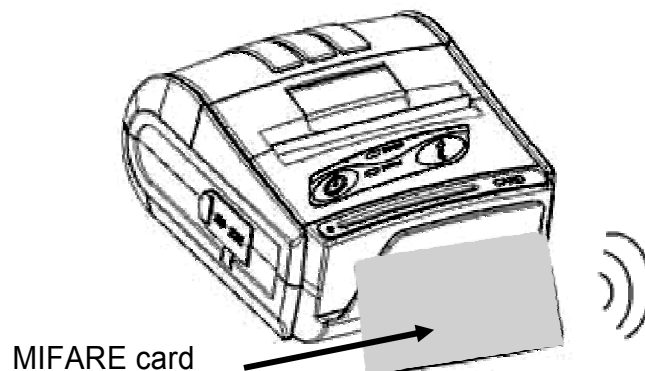

To use the smart card reader feature, special software must be used to read and process the card information. I you do not have card reading software, please consult your resaller to find out if this software is available or contact DATECS for recommendations on compatible third party software solutio.

DATECS DPP-350

Switch	OFF	ON
Sw1	Wide paper (78 mm)	Thinner paper (58 mm)
Sw2	Continuous paper mode	Label/Black mark mode*
Sw3	Hardware protocol	Xon/Xoff protocol
Sw4	Normal operation mode	Protocol mode

OFF	Continuous paper mode
ON	Black Mark searching mode



** The black mark searching mode is designed for accurate positioning starting print position on paper with printed information on it.*

[illegible]

The DIP switch location is shown in the illustration below:

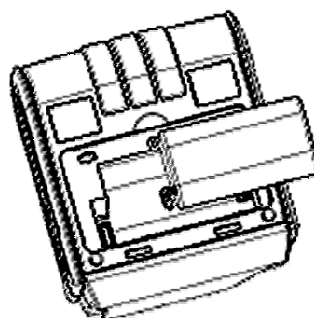
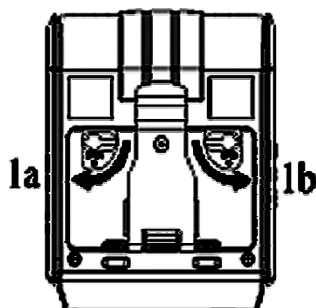

Printer Configuration

DPP-350 uses nonvolatile memory for storing some of the printer default configuration. The following table shows the available options:

Memory Switches (see GS command)	1000000010
BAUD RATE	115200 bps
POWER OFF TIME	10 min
PRINT DENSITY	100%
CHARACTER TABLE	WESTERN (1252)
PAIRING INFO	[SAVE=NO]

To change the settings:

1. Switch OFF the printer.
2. Press and hold the **ON/OFF** button. The **STATUS LED** flashes **GREEN** and after about 6 sec holding the **ON/OFF** button **STATUS LED** flashes **RED** and then turns **RED**.
3. Release the **ON/OFF** button and wait for the printer to print out the current memory settings and instruction.

The pressing **LF (YES)** – confirms changes.

The pressing **ON/OFF (No)** – cancels changes.



**To exit the hardware menu –
hold the ON/OFF button
for more than 1 sec.**



**Care must be taken when
changing factory preset
configuration information.**

Memory Switches Setup

DPP-350 has 10 memory switches, which have the following action:

Flag	OFF	ON
1	Power ON/OFF sound disabled	Power ON/OFF sound enabled
2	CR (ASCII code 13) is not executed	CR is executed LF (ASCII code 10)
3	LF (ASCII code 10) is executed	LF (ASCII code 10) is not executed
4	LF immediately after CR as selected by flag 3	LF immediately after CR is not executed
5	Default is Font A (12x24)	Default is Font B (9x16)
6	“Cover open” sensor monitored	“Cover open” sensor disabled
7	Disable IrDa module	Enable IrDa module
8	Bluetooth in DISCOVERABLE mode	Bluetooth in NONDISCOVERABLE mode
9	USB interface disabled	USB interface enabled
10	USB in mode HOST	USB in mode DEVICE

To change the settings:

1. Switch OFF the printer.
2. Press and hold the **ON/OFF** button.
The **STATUS LED** flashes **GREEN** and after about 6 sec holding the **ON/OFF** button **STATUS LED** flashes **RED** and then turns **RED**.
3. Release the **ON/OFF** button and wait for the printer to print out the current memory settings and instruction.
4. Follow the printer instruction to make the necessary changes.

```

SW1  ENABLE SOUND ?
SW2  EXECUTE <CR> AS <LF> ?
SW3  DISABLE <LF> COMMAND ?
SW4  N/A
SW5  N/A
SW6  N/A
SW7  N/A
SW8  DISABLE DISCOVERABILITY ?
SW9  ENABLE USB INTERFACE ?
SW10 USB IN DEVICE MODE ?

CHANGE BAUD RATE ?
CHANGE AUTO OFF TIME ?
CHANGE PRINT DENSITY ?
CHANGE CHARACTER TABLE ?
CHANGE PAIRING INFO ?

SAVE SETTINGS ?

```

The pressing **LF (YES)** – confirms changes.

The pressing **ON/OFF (No)** – cancels changes.



Care must be taken when changing factory preset configuration information.

Saving and Clearing PAIRING Info

When saving **PAIRING** Information, the printer Bluetooth information of the last device connected (paired) to the printer. Saving **PAIRING** info prevents the printer from asking for passkey upon initialization. The process for using this option is described below:

To speed this programming process, you may bypass the memory switch settings by indicating "NO" via pressing of the ON/OFF button when the printer prints "CHANGE MEMORY SWITCHES" as shown on page 18. This will advance you to the next level of setting where pairing can be found. The default **PAIRING** info option is **[SAVE=No]**.

```
SW1  ENABLE SOUND ?  
SW2  EXECUTE <CR> AS <LF> ?  
SW3  DISABLE <LF> COMMAND ?  
SW4  N/A  
SW5  N/A  
SW6  N/A  
SW7  N/A  
SW8  DISABLE DISCOVERABILITY ?  
SW9  ENABLE USB INTERFACE ?  
SW10 USB IN DEVICE MODE ?  
  
CHANGE BAUD RATE ?  
CHANGE AUTO OFF TIME ?  
CHANGE PRINT DENSITY ?  
CHANGE CHARACTER TABLE ?  
CHANGE PAIRING INFO ?  
  
SAVE SETTINGS ?
```

To save PAIRING Info:

1. Change the **PAIRING** Info option to **[SAVE=YES]**.
2. Confirm **SAVE SETTINGS** pressing **LF**.
3. Turn the printer ON and it will PAIR with the first **Bluetooth device**.
4. The printer will now remember the **PAIRING** information and not prompt user for a passkey on every printer initialization.

To clear PAIRING Info:

1. Change the **PAIRING** Info option to **[SAVE= No]**.
2. Turn ON the printer and PAIR the new **Bluetooth device** to the printer.
3. The printer will prompt user for a passkey on every printer initialization.

Connecting Device

The DPP-350 is designed to use different method of communications. The connection can be realized by a serial port, USB or Bluetooth. The figures below show how to attach the different devices to the DPP-350:

Serial/USB (Cabled) Version:

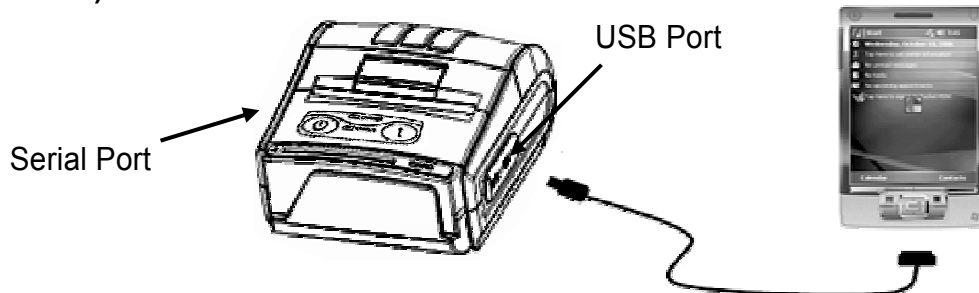

Bluetooth (Wireless) Version:

The DPP-350 Bluetooth version uses Bluetooth wireless technology to connect to Bluetooth enable devices. See "BluetoothSetup" section for details.



Communication Configuration:

Communication options	Memory Switch Options (from 1 to 10)	Hardware Switch Options (1, 2 3, 4)
With PDA device • Via Bluetooth/USB/Serial	***** 0 1 0	*, OFF, OFF, ON
With PC (using Windows printer driver) • Via Bluetooth/USB/Serial	***** 0 1 1	*, OFF, OFF, OFF
With PC in Service mode • Via Serial Interface	***** 0 1 1	*, OFF, *, ON



* Depending on user requirements can be 0 or 1.

When not using Driver/SDK developer tools, set DIP Switch 4 to OFF.

Bluetooth Setup

Bluetooth setup enables the printer DPP-350 included Bluetooth option to communicate with other Bluetooth devices. For this purpose, use the corresponding to your device Bluetooth manager.

The following is a brief explanation on how to **[PAIR]** your Bluetooth DPP-350 to PDA and Smartphon.

BlackBerry Devices:

Add Device or Pairing Bluetooth peripherals to BlackBerry devices require the use of the device Bluetooth manager. The image on the right shows a typical BlackBerry Bluetooth manager.



WindowsMobile Devices:

Creating a New Partnership or Pairing Bluetooth peripherals to your WindowsMobile device require the use of the device Bluetooth manager. The image on the right shows a typical WindowsMobile Bluetooth manager.



Palm Devices:

Add Device or Pairing Bluetooth peripherals to your Palm devices require the use of the device Bluetooth manager. The image on the right shows a typical Palm Bluetooth manager.



When adding / pairing the DPP-350 as a Bluetooth device, use the [0000] pairing key when prompted.

Loading Drivers for DPP-350:

To print information from your device it is necessary to install DPP-350 printer drivers.

DATECS offers the following drivers for DPP-350:

DATECS ESC/POS printer drivers (on Windows NT/2k/XP/2k3+)

Windows printer drivers for all Datecs ESC/POS printers.

PrintSuite

PrintSuit is a pack of applications and drivers for **DATECS PP-50/55, CMP-10, DPP-250** and **DPP-350** printers on **Windows/PalmOS/Windows Mobile/Windows CE**.

There are no developer tools and SDKs inside!

PPDevelop

Drivers, SDK, documentation and exemplary programs in different languages, giving developers access to all the functionality of the printers and optional modules. Current versions of application programs, drivers and SDK are distributed online and are available for download at the website, indicated below:

www.datecs.bg

Loading DPP-350 drivers for PDA or Smartphones:

BlackBerry devices:

BlackBerry Decktop Manager, shown in the figure on the right is used to load third party software on your device. Please, review your device's documentation on how to use the Application Loader Option to load software on to your device.

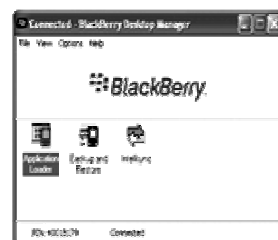

Windows Mobile Devices:

Active Sync Manager shown in the figure on the right is used to load third party software on your device.

Please, review your device's documentation on how to use the **Active Sync Manager** to load new software on to your device.

In most of cases you only need to run the DPP-350 installer to start the instalation.

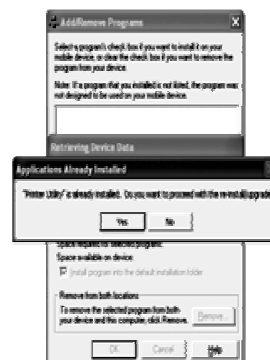

PALM devices

Palm Install Manager Application shown in the figure on the right is used to load third party software on your device. Please, review your device's documentation on how to use the **Palm Install Manager Application** to load new software on to your device.

In most of cases you only need to drag & drop DPP-350 PRC files in installer and click ADD.



Charging the Battery

DPP-350 uses a rechargeable Lithium Ion battery pack. Before first use, the DPP-350 battery pack should be charged for at least 4 hours.

To prevent electrical damage to the DPP-350 and/or battery pack, please use approved AC Charger only.

Charging the battery and the **CHARGE LED** status are shown in the illustration below:

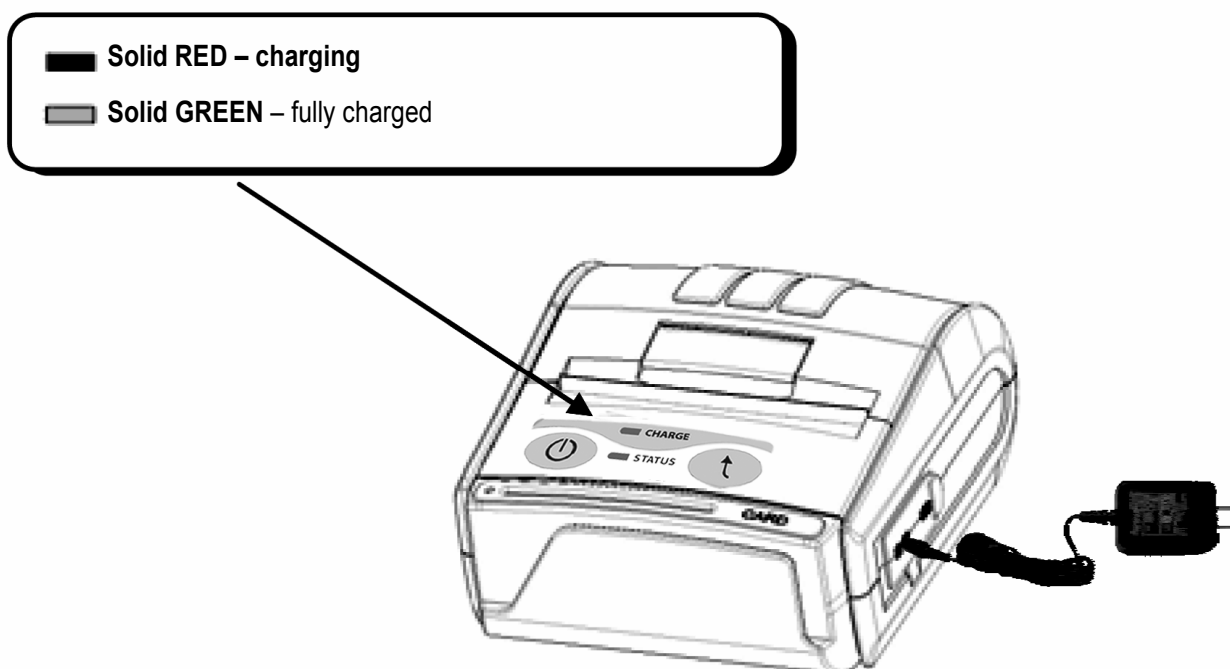

The Lithium Ion battery pack should be fully charged before use to ensure long battery life.

Replacing Battery

To replace the battery in the DPP-350 thermal printer follow the steps below:

1. Turn over the DPP-350 and place on a flat surface.
Rotate the (2) locking levers as shown in the figure on the right.

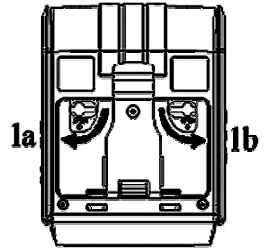

2. Lift the battery cover as shown in the figure on the right.

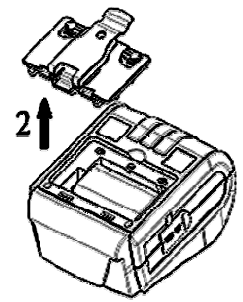

3. Lift the battery as shown in the figure on the right.

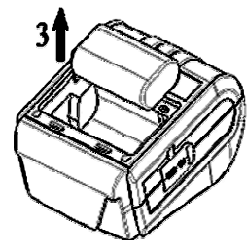

4. Detach the battery as shown in the figure on the right.
Reverse Steps 1-4 to install the new battery pack.

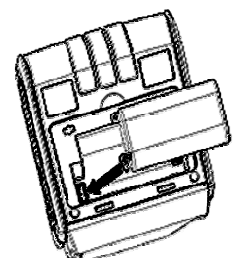

Loading Paper

DPP-350 uses a drop-and-load design making paper loading easy and trouble free. To load paper, simply lift up the paper cover latch and drop in the new roll as shown in the steps below.

1. Lift the paper cover latch to unlock the paper cover as shown in the figure on the right.



2. Lift the paper cover.
3. Drop the new roll as shown in the figure on the right



The thermal roll must be placed as shown in the figure on the right – the thermal surface of the media must be faced to the thermal head.

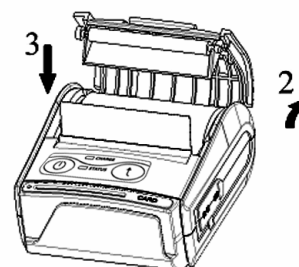

4. Close the paper cover until it snaps lock.



Be sure to pull at least 12 mm or more of media above the top of the printer before closing.

SELF TEST printing

Short SELF TEST



Press and Hold the **LF** button, while **Power On** the printer. Release – **after ~ 0.5 sec and after the 1-beep**. The printer will print a **Short Self Test**, which contains **information about**:

- Printer's model; Firmware version;
- Serial number;
- Interface;
- Baud rate;
- Flow control;
- USB mode;
- Black Mark mode;
- Protocol mode;
- Reader module;
- Intensity;
- Auto Off Time;
- Temperature;
- Date and Time;
- Battery;
- Switches.

The **Short SELF TEST** looks as shown below:

DATECS *Portable Printer*

```

MODEL DPP - 350   Version 1.12
Serial number:      AAA000001BB07
Interface:          RS232
Baud rate:          115200 bps
Flow control:       Hardware
USB mode:           Disabled
Black mark mode:    Disabled
Protocol mode:      Disabled
Reader module:      DPP350RMS V1.04
Intensity:          100 %
Auto off:           10 min
Temperature:        30°C
Date & time:         OCT/19/07 11:47
Battery:            7.5 V 
Switches:            ON OFF
                    1234 1234567890

```

Troubleshooting

If you're having printing problem refer to the table below for possible causes:

No	Problem	Possible Causes
1.	Paper feeds after issuing a print job, but no printed text visible on paper.	Thermal media is specially coated on outside of roll. Remove paper roll and reload properly. See section "Loading Paper" for details on loading paper. Paper cover not installed properly. See section "Loading Paper" for details on replacing paper cover.
2.	STATUS LED blinks RED continuously.	Printer out of paper or Paper not properly loaded. See section "Loading Paper" for details on loading paper.
3.	Text and/or graphics are printed very light.	Battery voltage low. See section on charging battery pack. Thermal media not imaging correctly. Verify that you are using the recommended thermal media.
4.	Strange characters are printed when printing.	Battery voltage low. See section on charging battery pack.
5.	STATUS LED flashes green	Battery voltage low.
6.	STATUS LED flashes green/red and printer stops printing.	The printer thermal head is overheat. When the printer head temperature returns to normal the STATUS LED lights green and the printer continues to print.
7.	Printer stops responding to print and paper feed commands.	Remove battery for 5 seconds and reconnect battery.
8.	Printing is light or missing only on half of the print width.	Paper cover not properly installed. See section on loading paper. Mechanism jarred loose. Contact technical support.

No	Command	Description
1	BEL	Sounds the buzzer
2	HT	Horizontal Tab Command
3	LF	Printing a line and Paper Feeding command
4	FF	Printing and paper feeding to the black mark position
5	CR	The operation of the command depends on the state of the configuration flags 2, 3 and 4
6	DC2 =	DC3 (Ruled line) commands sequence start
7	DC3 (Sets the ruled line ON
8	DC3 +	Sets the ruled line off
9	DC3 -	Selects ruled line A
10	DC3 A	Selects ruled line B
11	DC3 B	Clears selected ruled line buffer
12	DC3 C	Sets a single dot in selected ruled line buffer
13	DC3 D	Ruled line pattern set
14	DC3 F	Ruled line line set
15	DC3 L	Selects ruled line combine mode
16	DC3 M	Ruled line 1 dot line print
17	DC3 P	Ruled line n dots line print
18	DC3 p	Ruled line image write
19	DC3 v	Canceling print data in page mode
20	CAN	Printing data in page mode
21	ESC FF	DC3 (Ruled line) commands sequence start
22	ESC RS	Sounds the buzzer
23	ESC SP	Setting character spacing
24	ESC #	Setting EURO symbol position
25	ESC \$	Specifying the absolute horizontal position of printing
26	ESC %	Selecting/Canceling the printing of downloaded user character sets
27	ESC &	Selecting user character set
28	ESC !	Specifying printing mode of text data
29	ESC *	Printing graphical data
30	ESC +	Switchs OFF the printer
31	ESC -	Selecting/Canceling underlining
32	ESC .	Printing self test/diagnostic information

33	ESC 2	Specifying 1/6-inch line feed rate
34	ESC 3	Specifying line feed rate n/203 inches
35	ESC <	Changes print direction to opposite
36	ESC =	Data input control
37	ESC >	Selecting print direction
38	ESC ?	Reading magnetic stripe card
39	ESC @	Initializing the printer
40	ESC CAL	Black mark mode sensor calibration
41	ESC D	Setting horizontal tab position
42	ESC E	Specifying/Canceling highlighting
43	ESC F	Filling or inverting the page area in page mode
44	ESC G	Specifying/Canceling highlighting
45	ESC I	Specifying/Canceling Italic print
46	ESC J	Printing and Paper feed n/203 inches
47	ESC L	Selecting page mode
48	ESC N	Reading programmed serial number
49	ESC R	Selecting country
50	ESC S	Specifying speed (bps) of the serial port
51	ESC T	Printing short self test
52	ESC U	Selecting/Canceling underlined printing
53	ESC V	Selecting/Canceling printing 90°- right turned characters
54	ESC W	Defining the print area in page mode
55	ESC X	Specifying max printing speed
56	ESC Y	Selecting intensity level
57	ESC Z	Returning diagnostic information
58	ESC \	Specifying relative horizontal position
59	ESC]	Loading the default settings stored in Flash memory
60	ESC ^	Saving current settings in Flash memory
61	ESC _	Loading factory settings
62	ESC `	Reading the Battery Voltage and Thermal head temperature
63	ESC a	Aligning the characters
64	ESC b	Increasing text line height
65	ESC c5	Enabling/Disabling the functioning of the button LF
66	ESC d	Printing and feeding paper by n- lines

List of Commands for ESC/POS Mode

DATECS DPP-350

67	ESC f	Select symbol '0' printing style
68	ESC i	Feeding paper backwards
69	ESC o	Temporarily feeding paper forward
70	ESC pair=	Enabling/Disabling PAIRING info saving in Bluetooth mode
71	ESC pwd=	Programming a new Bluetooth password (PIN)
72	ESC r	Full command for sounding buzzer
73	ESC s	Reading print settings
74	ESC u	Selecting code table
75	ESC v	Transmitting the printer status
76	ESC x	Setting the time interval for automatically switching Off the printer
77	ESC y BTH:	Bluetooth module settings adjustment
78	ESC {	Enabling/Canceling printing of 180° turned characters
79	GS FF	Printing in page mode and returning to standard mode
80	GS S	Specifying the absolute vertical position in page mode
81	GS)	Setting printer flags (memory switches)
82	GS *	Defining a Downloaded Bit Image (logo)
83	GS /	Printing a Downloaded Bit Image
84	GS :	Starting/ending macro definitions
85	GS B	Enabling/Disabling inverse printing (white on black)
86	GS C	Read the Real Time Clock
87	GS H	Selecting Printing position of HRI Code
88	GS L	Setting the left margin
89	GS Q	Printing 2-D barcodes
90	GS R	Filling or inverting a rectangle in page mode
91	GS S	Selecting 2-D barcode cell size
92	GS T	Selecting the print direction in page mode
93	GS U	Selecting standard mode
94	GS W	Setting the print area width
95	GS X	Drawing a rectangular box with selected thickness in page mode
96	GS Z	Printing the non blank page area only in page mode
97	GS \	Specifying the relative vertical position in page mode
98	GS ^	Executing macro
99	GS c	Setting the Real Time Clock
100	GS f	Setting the font of HRI characters of the barcode

101	GS h	Setting the height of the barcode
102	GS k	Printing a barcode
103	GS p	Settings for 2D barcode PDF417
104	GS q	Selecting the height of the module of 2D barcode PDF417
105	GS w	Selecting the horizontal size (Scale factor) of the barcode
106	GS x	Direct text print in page mode

Asian Languages Support

107	FS !	Specifying printing mode of two-byte text data
108	FS &	Selecting two-byte text mode (JIS or GB2312)
109	FS -	Selecting/Canceling underline mode for two-byte text mode
110	FS .	Canceling two-byte text mode
111	FS 2	Defining one custom Kanji character
112	FS C	Selecting Shift-JIS mode (Japanese version only)
113	FS S	Specifying character spacing for two-byte text mode
114	FS W	Selecting double size characters for two-byte text mode



* For details about commands for ESC/POS mode see Programmer's User.